

## Technical Data Sheet

**OSCAR**  
**elite**®



### Oscar Elite installation structure

The 27mm construction consists of 2mm adhesive, 20mm thick mineral board, base and topcoat Oscar Elite synthetic acoustic plaster totalling approximately 5mm, which is sprayed, trowelled and worked to optical requirements. The finish is visually hard and firm to the touch but with excellent sound absorption. As with all acoustic plaster, installations should be suitably protected in areas where damage is likely.

Oscar Elite acoustic plaster is installed by our own in house, trained staff in order to guarantee optimal workmanship.

### Fire performance ratings

#### UK fire test

Class 0 to BS476 Part 6

Class I to BS476 Part 7

#### European

A2-s1,d0

Significantly better than the requirements of the new Approved Document B providing little to no smoke and absolutely no droplets, assisting in the safe escape of occupants.

### Environmental

- Achieves M1 certification for Building Materials emissions.
- Recycled content: Glasswool: 75%.
- Recyclability: Disposal in accordance with local recycling/disposal rules.
- Embodied carbon: Can effectively lower the carbon footprint of a building project by sequestering rich stores of carbon for the life of the structure or application.

## Bonding to substrate

Oscar Elite can be applied onto plasterboard or directly onto concrete. Adhesion to other surfaces is possible; please contact Oscar Acoustics for advice. Domes & barrel vaults are not a problem due to the products ability to be sanded into smooth shapes.

## Design assistance

- BIM Objects available
- Included within all NBS software.
- Standard details drawings for most situations.
- Bespoke detailing solutions possible.
- Recessed & surface mounted items possible.

## Maintenance & cleaning

Dust is removed by lightly brushing or vacuuming with a soft brush head. It is also sometimes possible to blow dirt from the surface with a high-pressure air hose. A wall or a ceiling can be entirely over sprayed in acoustic plaster in the same or a change of colour. Over painting must be done by spraying and not roller to prevent serious impact on the acoustic performance and damage to the product. Advice must be sought from Oscar Acoustics before painting as incorrect application can result in damage of the product.

## Repairing & servicing

A major benefit of Oscar Elite is its ability in most cases, to be locally repaired within reason, negating the need for expensive and inconvenient pre-handover resprays, as with many products similar in appearance. For more serious damage, it is possible for us to lightly sand and reapply the topcoat.

## Recessed items

Recessed services e.g. spot lighting will require a halo spacer to match the material depth. Oscar Acoustics manufacture and install stainless steel halo spacers (drawing available) to the same size as the hole cut out. Stop beads may be required around openings which again we can supply and install. Specially designed access hatches are also available through Profab, enabling the Oscar Elite to continue across the hatch door. Problems can arise from using other hatches. These items are at extra cost and are to be purchased direct from the Profab. Please contact Oscar Acoustics for details and item code. Surface mounted fittings e.g. hanging/pendant lights will require pattresses to match the material depth. Please contact Oscar Acoustics for further advice.

**Please Note:** 90% of flangeless fittings do not work properly with any acoustic finish. If you are specifying a flangeless fitting, please contact Oscar Acoustics for advice.

## Acoustic results

Our technical department offer free advice and acoustic calculations on the use of our products.

## Oscar Elite acoustic plaster absorption coefficients

Depth	125Hz	250Hz	500Hz	1kHz	2kHz	4kHz	NRC	$\alpha_w$
27mm	0.10	0.50	0.85	0.85	0.80	0.80	0.80	0.80
47mm	0.40	0.80	0.95	0.95	0.90	0.90	0.90	0.95

Acoustic plaster test DATA certified by TNO Technology University Delft NL. Acoustic testing has been carried out against solid concrete. Increased performance can be achieved when applying onto plasterboard with an air gap.

## Colour

The standard colour is arctic white. For bespoke colours, please send us your colour requirement using a Dulux paint reference or RAL. If over painting, please contact Oscar Acoustics for instructions first.

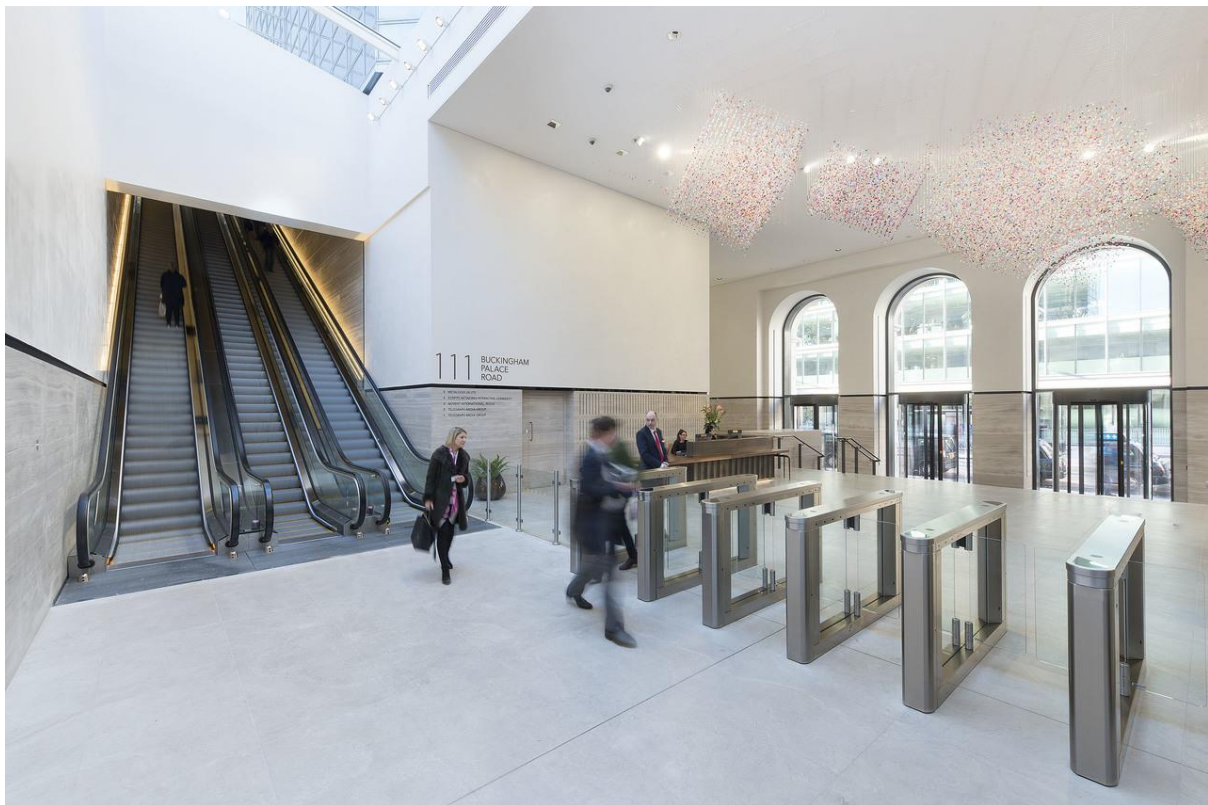

### Oscar Elite photo credits:

1<sup>st</sup> image: One Mabledon Place, The Halo Building. Integra Contracts / ISG, Steffian Bradley Architects & Gary Britton photography.

2<sup>nd</sup> image: 111 Buckingham Palace. Eric Parry Architects, Collins Construction & Tony MacLean photography.